

Welcome to the 2020-2021 school year!



We are looking forward to welcoming all of our new and returning students back to **John Galt Public School** this September!

As you are aware, the Upper Grand District School Board has put extensive plans in place for the school year. Our school has now created plans that include both operational changes (how we manage the people and resources within the school) and health and safety changes (our response to the COVID pandemic). We hope this document will help answer your questions about the specifics about the opening day and first week of school.

Please also look through our board Parent Handbook, for more detailed information about the changes for this school year. There is also a link to the Board Website and the Parent Question and Answer (Q&A) page.

[Link to Parent Handbook](#)

[Link to Board Website and Parent Q & A](#)



Staggered Entry

We will be having a “staggered entry” for all students in K - Grade 8 classes this year. This means that all students will come to school with approximately half of their classmates on alternating days for the first two weeks of school. This will allow us to carefully review and establish safety routines with fewer students in the building. Parents should have received a phone message identifying which days their child will be at school. Please note that the first day of school has been set as September 10th, unless your child is in our Life Skills class, they will start on the 8th and attend every day.

ELEMENTARY IN-PERSON LEARNING: JK to Grade 8 schedule of staggered entry - Alphabetical by last name					
	Monday Sept. 7	Tuesday Sept 8	Wednesday Sept 9	Thursday Sept 10	Friday Sept 11
All students (JK-Grade 8)	Labour Day Holiday	Developmentally Delayed classes only - full day	Developmentally Delayed classes only - full day	Last name A-L only - full day	Last name M-Z only - full day
	Monday Sept 14	Tuesday Sept 15	Wednesday Sept 16	Thursday Sept 17	Friday Sept 18
All students (JK-Grade 8)	Last name A-L only - full day	Last name A-L only - full day	Last name M-Z only - full day	Last name M-Z only - full day	All JK - Gr 8 students attend full day

Before Coming to School

COVID-19 Screening:

- All parents must screen their children every day before leaving home for symptoms of COVID-19. If there are symptoms, children need to stay home from school. If COVID-19 is suspected, testing is recommended.
- Link to [self-screening tool](#)

What to Bring to School

Please keep your child's personal items to a minimum! To support a safe and comfortable environment, students are asked to bring the following items clearly labelled with the student's name:

- Backpack for personal belongings
- Face masks - they may need more than one
- Personal water bottle (please label)

- Lunch bag
- Seasonal outdoor wear (we are not requiring 'indoor shoes' at this time)
- Only those items that are necessary for the day (e.g., pencil case, calculator, pens, pencils) *please see our website for a list of suggested back to school supplies
- Students may bring their own devices, but they must be wiped by the student upon entry and before leaving at the end of the day

Note: Lockers and change rooms will not be used for the 2020-2021 school year. Students will be required to keep all personal belongings with them throughout the day.

Note: Additional information will be provided to families about how the school will help students manage winter boots and coats when cold weather arrives.

How Will I Know What Class My Child is In?

You will receive a phone call from the school before the first day, indicating who your child's tentative teacher is and where to line up on the first day.

Reopening Procedures

Morning Drop Off:

On the **first day** students are asked to go right to their line. Other school days students will be allowed to go to their assigned zones on the yard and then asked to line up at the bell.

Class lineup spots will be painted on the tarmac to indicate where students should line up once the bell rings.

Please drop your child/children off as close to the bell as possible.

If possible allow children to walk to the back tarmac on their own (parents are encouraged to use the catwalks on either side of the school as their drop off and pick up locations). Parents that do come to the tarmac must maintain physical distancing with other parents and students.

Bus students will be met by a teacher on duty and students will walk to their assigned "zones"

on the yard.

Parents are asked to make appointments and/or call ahead to enter the school. If your child needs to take medication at school, we will have a staff member on the tarmac with forms for you to fill out on the first day (please be prepared to fill this form out at home or in your car).

When students arrive (after the first day of school) they will need to go to their assigned zone on the yard. Grade 1-6 zones will be on the tarmac and half of the field. Grade 7 & 8 zones will be the back half of the field. Grade 1-6 students are asked to walk to the front of their zone and enter from the tarmac side. Grade 7 & 8 students are asked to walk around the back side of the field and enter their zone from the back of the field.

When the bell rings, Grade 1-6 students will go directly to their line up spots. Grade 7 & 8 students will line up at the front edge of the field, in their zone and wait for a teacher to direct them in.

Designated Entry Doors:

To facilitate speedy entry in the morning and to limit unnecessary travel through the building, each grade/class will be assigned an entry/exit door. This will be the only door that students will use for entering the building, for accessing outdoor activities (and recess) and departing at the end of the school day.

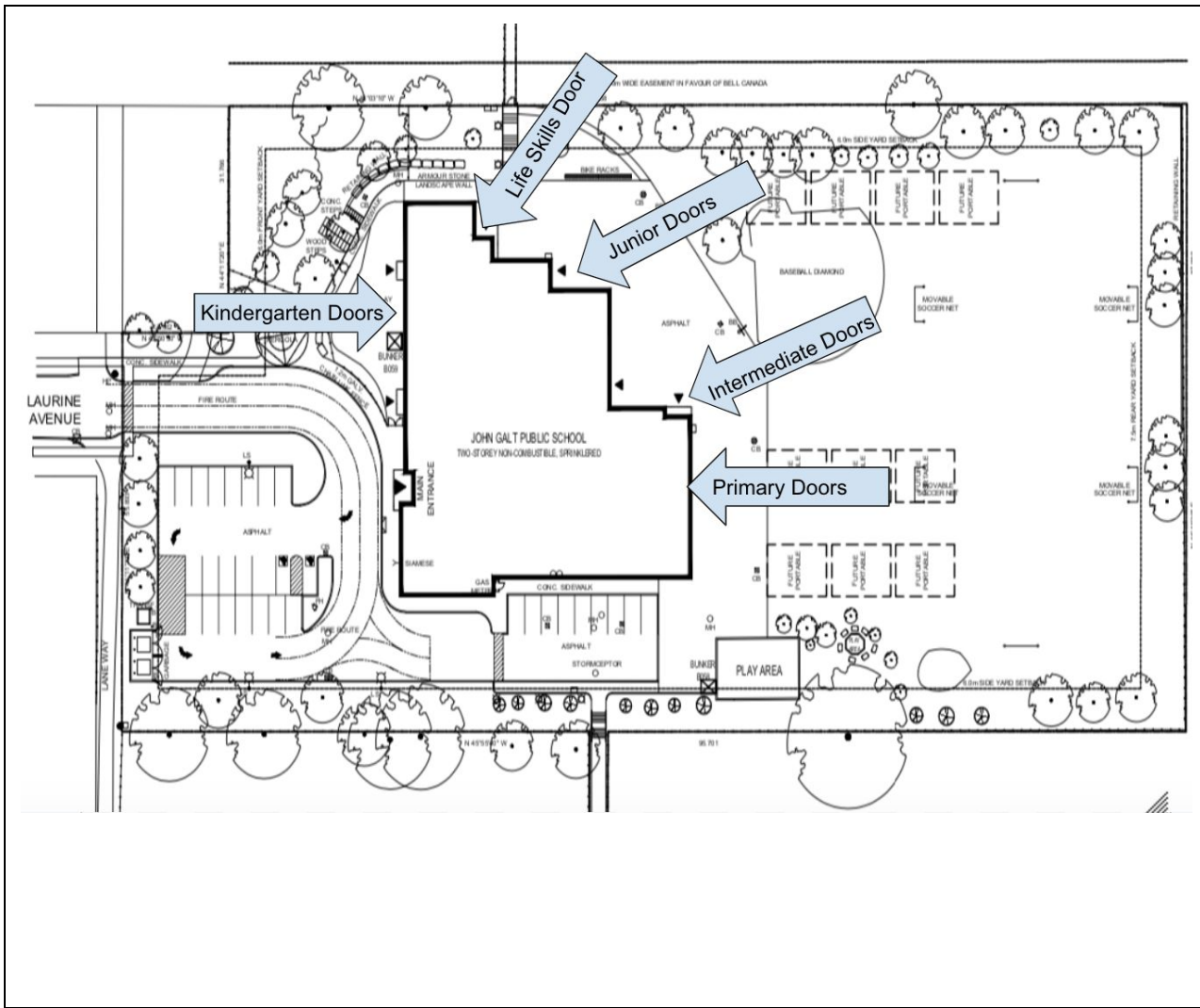

School Greeters:

A “Greeter” will meet late students at their assigned point of entry first thing in the morning. Students will be reminded to put on a mask and to socially distance as they enter the building and they may assist with hand sanitizer.

Teachers will meet students at their entry doors, remind them to put masks on, to maintain physical distance and to provide hand sanitizer as they enter the building.

Late Arrival:

Students that arrive after the 8:25 bell will need to enter through the front door of the building. Our Greeter will be there to bring the students in, provide hand sanitizer, help with masks if necessary, remind about physical distancing and direct students to get a late slip from the main office. Late slips will be shown to classroom teachers and then recycled.

Entering the Building:

Classes will enter the building, one class at a time, as directed by staff. Hand sanitizer will be provided and students will be asked to put on their masks before entering. Classes will enter in order of which classes are furthest from the door first and walk on the right hand side of the hall and go straight into their classroom.

Recess Information:

Students will have an assigned zone on the yard for their class to play. Teachers will practice walking to and from this zone and pylons will be used as indicators between zones. Students can only play with students from their class. The **playground structure and the sand pits are currently closed.**

Students will be provided coloured lanyards (breakaway style)(one colour per class). These lanyards will help staff decipher which recess zone the students should be in and will also double as a mask holder, to make it easier for students to don and doff their masks during school entry and exit.

Lunch Procedures:

Students will sit at their desks to eat lunch. Families are encouraged to send food in tupperware containers. Recyclable material will be sent home to be disposed of. Handwashing will happen before students begin eating and after they are done.

We will not have access to the snack/lunch bins that we usually have to provide extra food for students that forget a lunch or need more food. We will have some grab and go, individual items as a quick to go snack.

Parents will not be allowed to bring student lunches into the building and ordering services are not allowed at this time.

End of Day Procedures:

Kindergarten and Primary classes will be picked up from their Entry/Exit doors.

Junior and Intermediate classes will be dismissed by their teacher from their Entry/Exit doors.

All students need to leave the school grounds immediately when the bell rings.

Communication with the School

All communication with the school needs to be via a phone call or email. Teachers will be communicating with you in terms of how best to reach them.

Agendas will not be used this year, electronic communication is encouraged. Teachers will be setting up their Google Classrooms for use at school and home.

We will be sending home our regular package of information on the first day of school. Please complete this and return it to your child's teacher as soon as possible.

Access to the School

Only essential visitors are permitted inside the school (e.g., maintenance personnel).

All parents and visitors will not be permitted inside schools during the pandemic, except in case of emergency. At entry and dismissal times, parents are to remain outside the school (at the edge of the tarmac) and adhere to physical distancing protocols.

Technology

If you borrowed a chromebook or if your child/children have school technology at home with them, please bring it back to school on the first day. A teacher will be on the tarmac looking to collect all returned tech. We will disinfect it and record that it is returned and then get it back into classrooms.

Please know that these are the starting points for our reopening guidelines. Protocols may change at any time as we take our direction from the school board and Public Health.

We appreciate your support and patience as we work through our reopening plan and get our Jaguar family back to the building.



Amanda Myer
Principal
John Galt Public School