

TRUE NORTH:

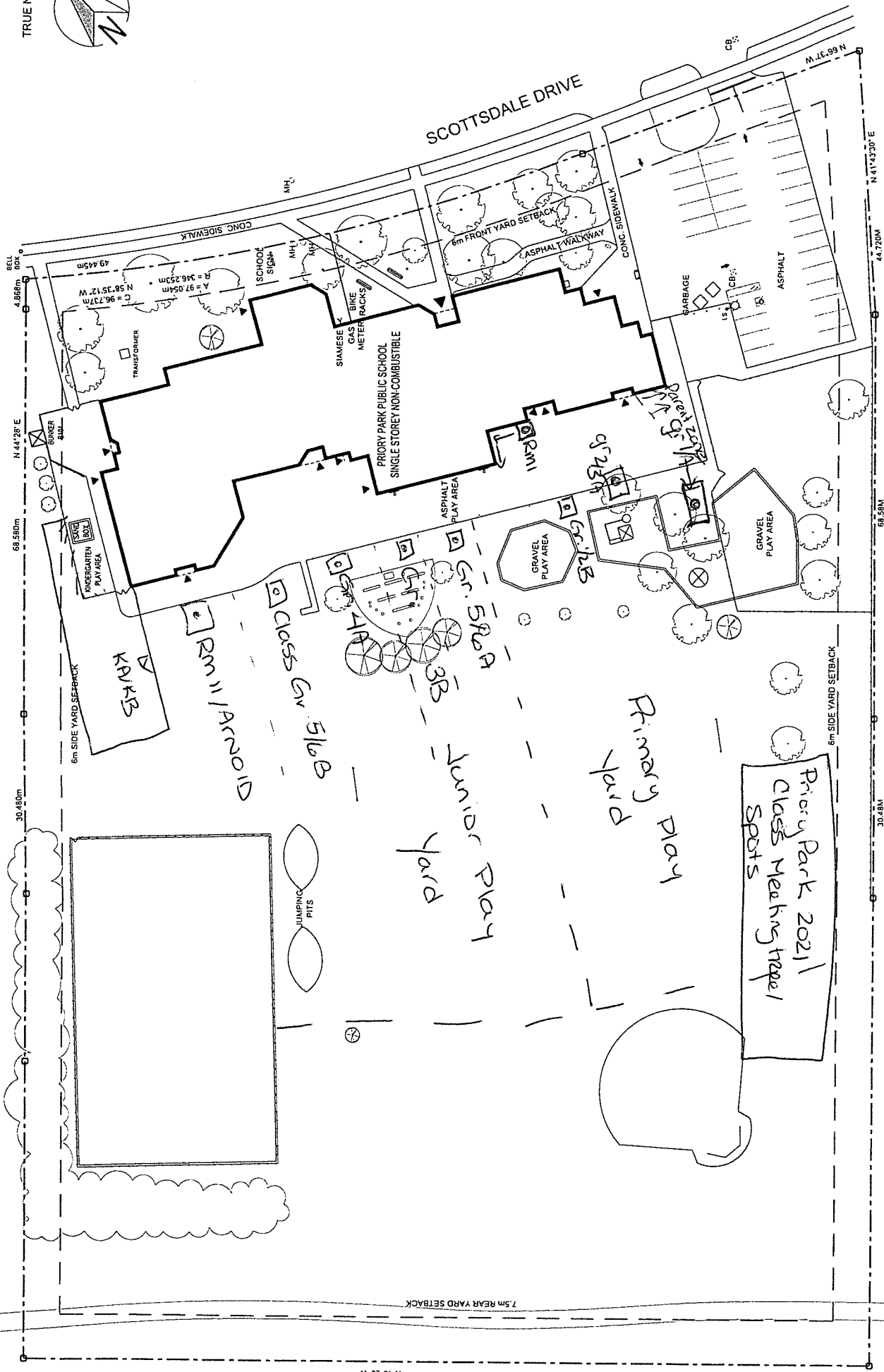

2	APR 2019	RENO 2017 ADDED
1	OCT. 2017	DRAWING REVISED
No:	DATE:	REVISION:

SCALE: 1:900
DRAWING NO: A-101

DRAWING TITLE: **SITE PLAN**

SCHOOL: **PRIORY PARK PUBLIC SCHOOL**
275 SCOTTSDALE DRIVE
GUELPH, ON, N1G 3A1



UPPER GRAND DISTRICT SCHOOL BOARD
500 Victoria Road North, Guelph, Ontario, N1E 6K2